



Quality and reliability is our tradition

KYORITSU

Non-Contact Safety Phase Indicator KEW 8035

Safe Testing without direct contact with live wires!!



For cables from $\phi 2.4$ to 30mm



Can clip insulated cables



Magnet attachment



Check for Phase rotation and Presence of open phase



- New technology permits safe testing, without the need of direct contact between probes and live wires.
- The insulated crocodile clips can clip insulated cables from $\phi 2.4$ to 30mm.
- Phase rotation is indicated by the rotary illumination of LEDs and logical audible tones.
- The instrument can be fixed to a metal panel via the magnet on the back side.
- Wide measuring range for 3 phase installations from 70V to 1000V AC.
- Complies with IEC 61010-1 CAT.IV 600V and CAT.III 1000V.



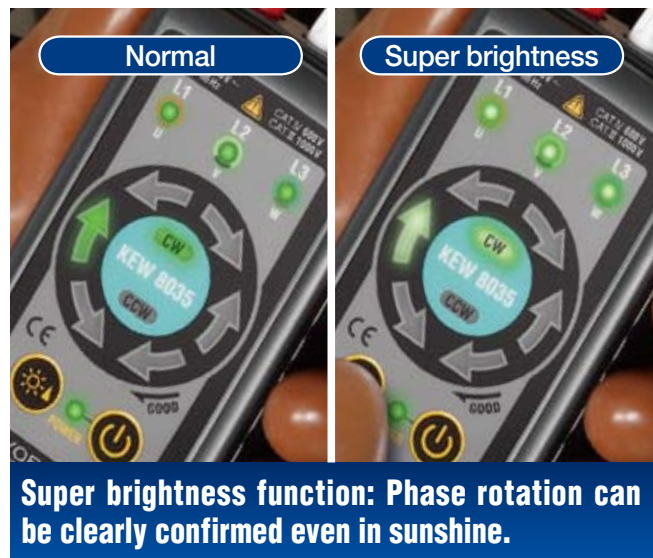
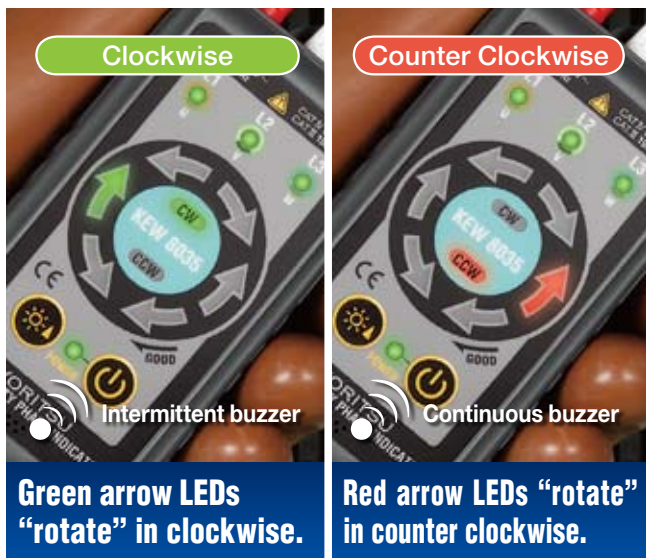

● KEW 8035 SPECIFICATIONS

Functions	Phase rotation (Clockwise or Counter Clockwise), Presence of open phase
Detection Method	Electrostatic induction
Measuring Voltage Range	From 70 to 1000V AC phase to phase (sine wave, continuous input)
Clamp Diameter Range	From ϕ 2.4 to 30mm insulated cables
Measuring Frequency Range	45 to 66Hz
Phase Rotation	Clockwise : Green arrow LEDs "rotate" in clockwise, Green symbol "CW" lits, Intermittent buzzer Counter Clockwise : Red arrow LEDs "rotate" in counter clockwise, Red symbol "CCW" lits, continuous buzzer
Visual Indication	Via LEDs with Super brightness function
Operating Conditions	Temperature/Humidity Ranges -10 to 50°C, 80% (no condensation)
Storage Conditions	Temperature/Humidity Ranges -20 to 60°C, 80% (no condensation)
Power Supply	Alkaline battery(LR6)×4 *Continuous use: Approx. 100 hours (Auto power off in about 10 min.)
Battery Voltage Warning	Power LED blinks if battery voltage is too low.
Test Leads	Double insulated cables, length approx. 70cm
Colours Code	L1(U) : Red L2(V) : White L3(W) : Blue
Applicable Standards	IEC 61010-1 CAT.IV 600V, CAT.III 1000V Pollution degree2 IEC 61326 IEC 61557-1, -7
Dimensions / Weight	112(L)×61(W)×36(D)mm / Approx. 380g
Accessories Included	9096(Carrying case), Alkaline battery(LR6)×4, Instruction manual



Safety Warnings :

Please read the "Safety Warnings" in the instruction manual supplied with the instrument thoroughly and completely for correct use. Failure to follow the safety rules can cause fire, trouble, electrical shock, etc. Therefore, make sure to operate the instrument on a correct power supply and voltage rating marked on each instrument.

■ For inquires or orders :



**KYORITSU ELECTRICAL
INSTRUMENTS
WORKS, LTD.**